

Individual Fieldbus nodes

CP2, CC2, CD2

New

Interface with the most widespread Fieldbus Protocols: Profibus-DP;
CANopen and DeviceNet

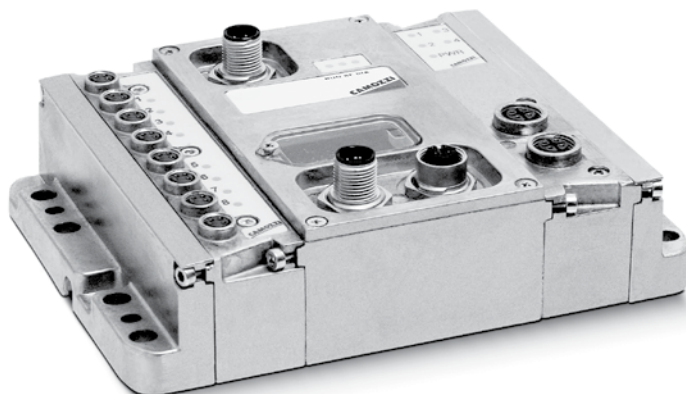

- » Maximum flexibility in use
- » Mounting in arduous conditions
- » Easily modifiable.

Electric output modules that can be coupled are: connection D-Sub- 37 pin for 8; 16; 24; 32 outlets or with two M12 connections for 4 outlets. Input modules have 8xM8 connections and allow the connection of sensors rated up to a max of 100mA. All communication modules are connected by plug and socket granting the maximum flexibility, and addressing is done by rotary switch for easy configuration.

The serial module CX2 can be used both integrated on different valve series (Series 3, Series H) and as external component. This device allows the connection of up to a max of 64 solenoids and 64 inputs on the base unit, so applications other than pneumatics are a possibility. Thanks to its aluminium support structure, this solution is IP65 rated with high mechanical strength. It is therefore suitable for mounting in arduous conditions.

GENERAL DATA

Number of digital output	64
Number of digital input	64
Maximum input absorption	1,5 A
Maximum output absorption	3 A
Signalling Led	CP2: 1 led green RUN, 1 led red DIA, 1 led red BF CD2: 1 led green IO, 1 led red NS, 1 led red MS CC2: 1 led green RUN, 1 led red DIA, 1 led red BF
FieldBus Protocol	CP2: Profibus-DP CD2: DeviceNet CC2: CanOpen
Maximum number of nodes	CP2: 32/127 CD2: 64 CC2: 127
Maximum Baud rate	CP2: 12 Mbit/sec CD2: 500 Kbit/sec CC2: 1 Mbit/sec
Logical supply voltage	24VDC (-15% / + 20%)
Power supply voltage	24VDC (for the tolerance, consider the total loads of the connected inputs)
Protection	overload and reverse polarity
Protection class	IP65
Conform with standards	EN-61326-1 EN-61010-1
Operating temperature	0-50°C
Material	Aluminium
Weight	250 g
Dimensions	130x68 mm

CODING EXAMPLE

CP2	3A	BC
-----	----	----

CP2	CP2 = Fieldbus Profibus Dp CC2 = Fieldbus CANOpen CD2 = Fieldbus DeviceNet
3A	0 = no module nA = numbers of modules 8 Input (n= 1+8)
BC	0 = no module nB = numbers of modules 4 output M12 duo nC = numbers of modules 8 output sub-d 37 pin nD = numbers of modules 16 output sub-d 37 pin nE = numbers of modules 24 output sub-d 37 pin nF = numbers of modules 32 output sub-d 37 pin (es. 3 modules A + 2 modules E= 3A2E)

Individual Fieldbus nodes

New

see the drawing on following page

Mod.	FieldBus Protocol
CP2	Profibus-DP
CC2	DeviceNet
CD2	CANopen

System description

New

2

The principal features are: electrical connections on the same side as the pneumatic connections, Bus-In Bus-Out system for connection to the Fieldbus network, double electrical supplies, one for control and the other for power. This version is capable of handling 64 inputs and 64 outputs.

The output modules can be positioned on the right hand side of the node and they provide either 2 x M12 or 37 pole Sub-D connection. In the same way it is possible to position the input modules on the left hand side, which provide 8 inputs with M8 connection.

All the elements can be easily inserted because of their direct connection to the plate.

It is possible to use this node directly integrated on pneumatic solutions such as Series 3 and Series H.

Each node is part of the serial system.

The addressing is done via rotary switches, with the Leds indicating the working state.

Manuals and configuration files are available on our website: www.camozzi.com in the Section Products/Download.

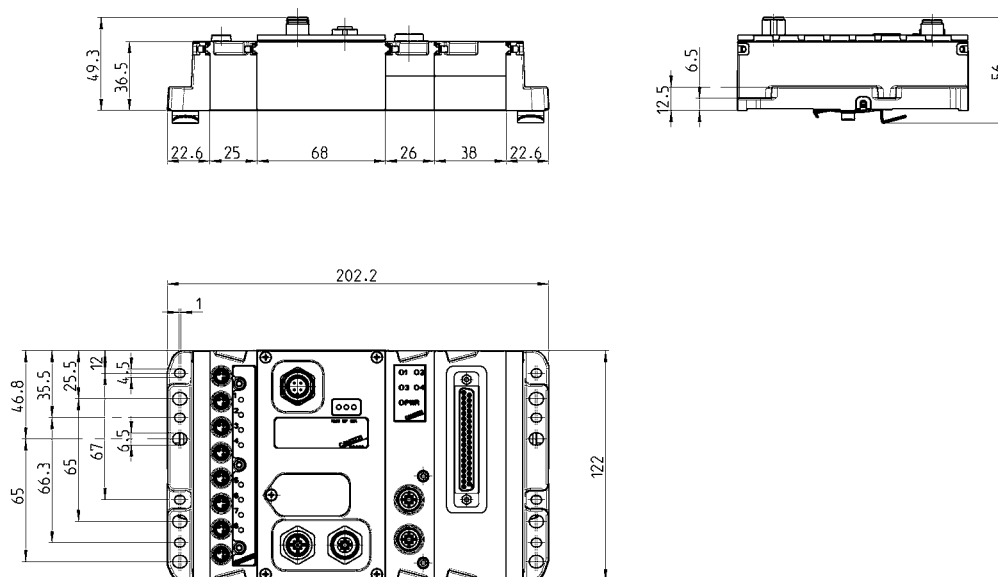

Digital output module (D-SUB - 37 pin) Mod. ME-xxxx-DD

New

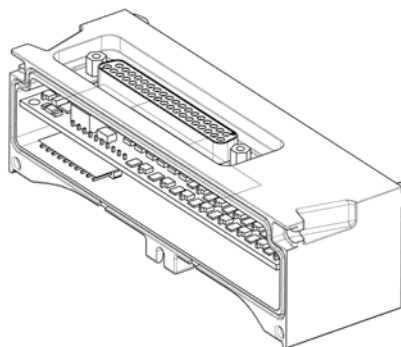

	ME-0032-DD	ME-0024-DD	ME-0016-DD	ME-0008-DD
Number of digital outputs	32	24	16	8
Connection	D-SUB 37 poles	D-SUB 37 poles	D-SUB 37 poles	D-SUB 37 poles
Connectors	1	1	1	1
Dimensions	130 x 25 mm	130 x 25 mm	130 x 25 mm	130 x 25 mm
Type of signal	24 V DC PNP	24 V DC PNP	24 V DC PNP	24 V DC PNP
Protection	Overload (150 mA in outlet)	Overload (150 mA in outlet)	Overload (150 mA in outlet)	Overload (150 mA in outlet)
Power consumption without load	5 mA	5 mA	5 mA	5 mA
Protection class	IP 65	IP 65	IP 65	IP 65
Operating temperature	0°C ÷ 50 °C	0°C ÷ 50 °C	0°C ÷ 50 °C	0°C ÷ 50 °C
Material	Aluminium	Aluminium	Aluminium	Aluminium
Weight	100 g	100 g	100 g	100 g

Digital output module 2xM12 DUO, (4 outputs), Mod. ME-0004-DL

New

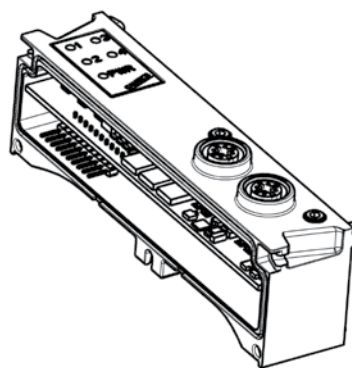

	ME-0004-DL
Number of digital outputs	4
Connection	M 12 5 Poles Duo
Number of connections	2 Female connectors M 12
Dimensions	130 x 25
Signalling	1 Yellow Led for each single outlet 1 Green Led for power supply presence on the module
Outlet voltage	24 V DC +/- 10%
Signal	24 V DC PNP
Protection	Overload - Supply voltage (150 mA)
Power consumption without load	10 mA
Protection class	IP 65
Temperature	0°C ÷ 50 °C
Material	Aluminium
Weight	100 g

Digital input Module Mod. ME-0800-DC (8 digital inputs)

New

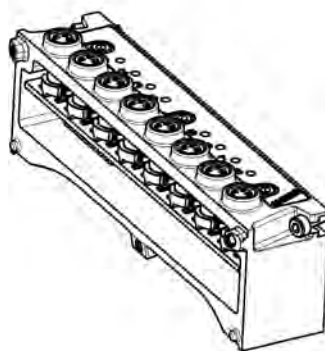

Number of digital inputs	8
Connection	M8 - 3pin
Module dimension	130x25 mm
Signalling led	yellow led for each inlet
Sensors supply	24VDC +/- 10%
Protection	overloaded (400 mA every 4 sensors)
Power consumption of the module without load	10 mA
Type of signal	PNP
Protection class	IP65
Operating temperature	0-50°C
Material	Aluminium
Weight	110 g

Mounting brackets



DIN EN 50022 (mm 7,5 x 35 - width 1)
Suitable for all manifolds.
The following is supplied:
2x plates
2x screws

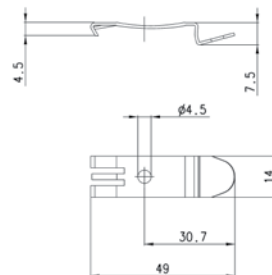

Mod.

PCF-E520

Power supply connector



Mod.

CS-LF04HB

Connector for Bus-In



Mod.

CS-MM05HC

Profibus DP

CS-LF05HC

CANOpen - DeviceNet

Connector for Bus-Out

New

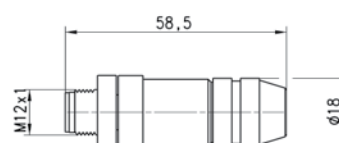

Mod.

CS-MM05HC

Profibus DP

CS-LM05HC

CANOpen - DeviceNet

Power supply angular connector

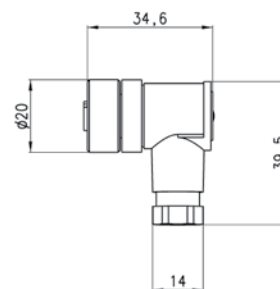

Mod.

CS-LR04HB

Bus-In angular connector

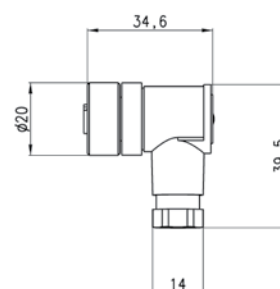

Mod.

CS-MR05HC

Profibus DP

CS-LR05HC

CANOpen - DeviceNet

Male connector with terminal resistance

New

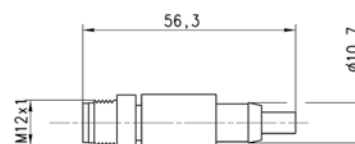

Mod.

CS-MQ05H0

Profibus DP

CS-MP05H0

CANOpen - DeviceNet

Blanking plug for inlets/outlets module

New



Mod.

CS-DFTP

Blanking plug M8 for inlets module

CS-LFTP

Blanking plug M128 for outlets module

Mounting brackets



DIN EN 50022 (mm 7,5 x 35 - width 1)
Suitable for all manifolds.
The following is supplied:
2x plates
2x screws

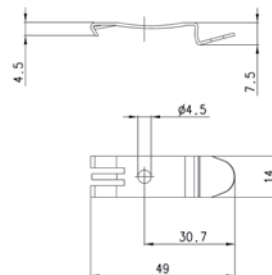

Mod.

PCF-E520

Power supply connector



Mod.

CS-LF04HB

Profibus connector



Mod.

CS-MM05HC

Profibus Dp

CS-LF05HC

CANOpen - DeviceNet

Connector for Bus OUT

New

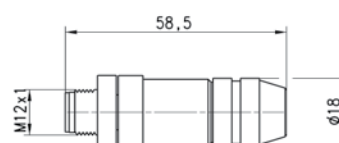

Mod.

CS-MM05HC

Profibus

CS-LM05HC

CANOpen - DeviceNet

Power supply angular connector

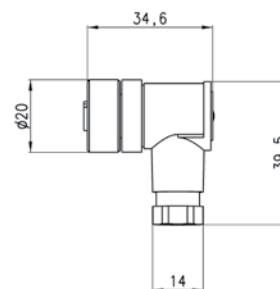

Mod.

CS-LR04HB

Bus-In angular connector

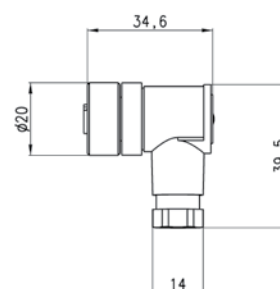

Mod.

CS-MR05HC

Profibus

CS-LR05HC

CANOpen - DeviceNet

Male connector with termination resistance

New

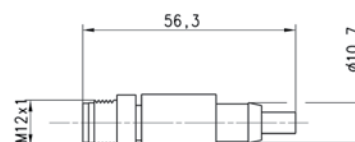

Mod.

CS-MQ05H0

Profibus

CS-MP05H0

CANOpen - DeviceNet

Blanking plug for inlets/outlets module

New



Mod.

CS-DFTP

Blanking plug M8 for inlets module

CS-LFTP

Blanking plug M128 for outlets module